

WEST SUSSEX COUNTY COUNCIL
((ADUR DISTRICT) (PARKING PLACES & TRAFFIC REGULATION)
(CONSOLIDATION) ORDER 2009)
(SHOREHAM-BY-SEA: DOLPHIN ROAD AMENDMENT)
(AND VARIOUS ROADS CONSOLIDATION) ORDER 2018

SHOREHAM/SOUTHWICK: LOCATIONS OF WAITING RESTRICTIONS

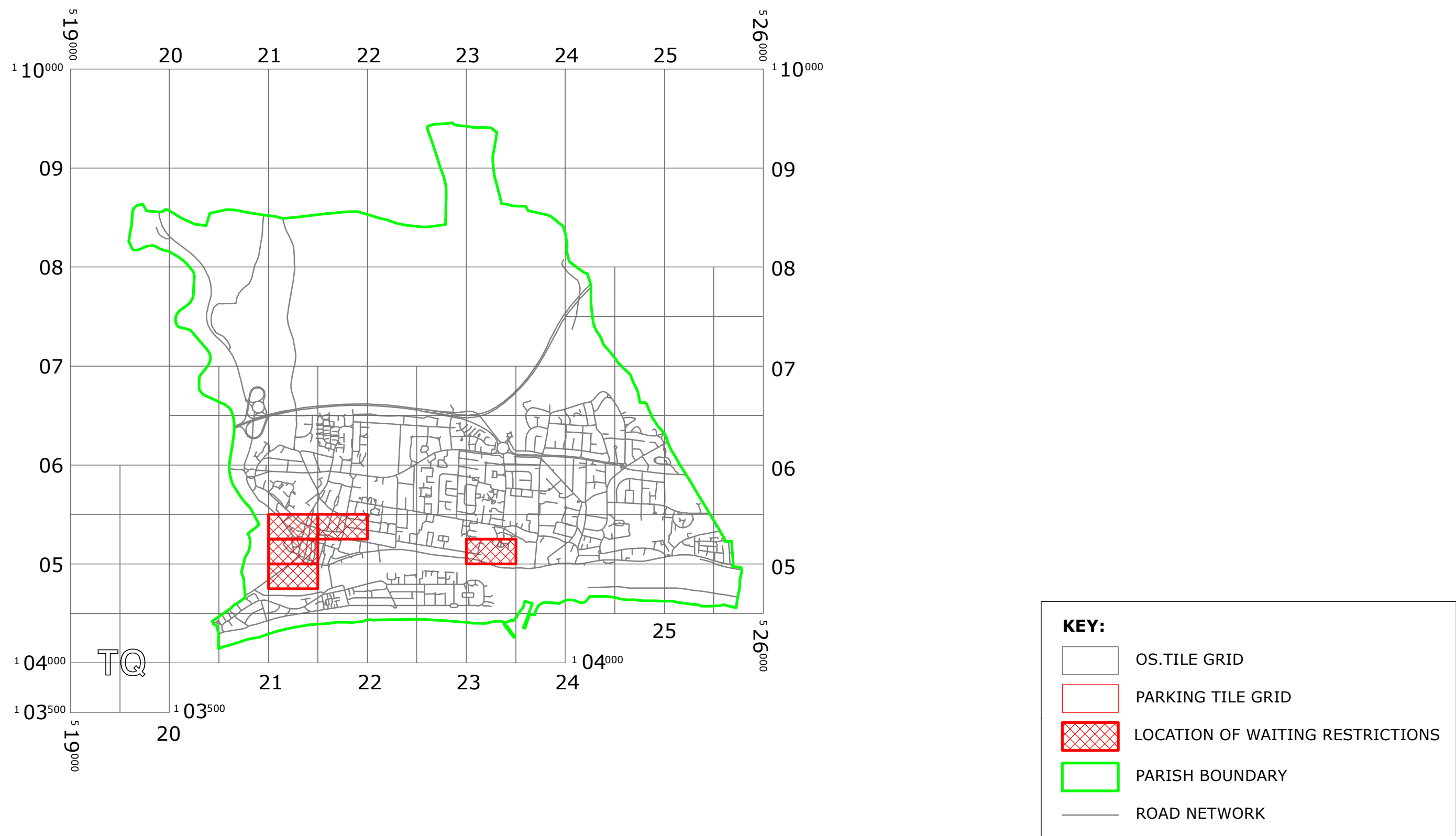

West Sussex County Council
Highways & Transport
The Grange
Tower Street
Chichester
West Sussex
PO19 1RH

WEST SUSSEX COUNTY COUNCIL
((ADUR DISTRICT) (PARKING PLACES & TRAFFIC REGULATION)
(CONSOLIDATION) ORDER 2009)
(SHOREHAM-BY-SEA: DOLPHIN ROAD AMENDMENT)
(AND VARIOUS ROADS CONSOLIDATION) ORDER 2018
LOCATION OF WAITING RESTRICTIONS



Reproduced from or based upon 2017 Ordnance Survey mapping with permission of the Controller of HMSO (c) Crown Copyright reserved.
Unauthorised reproduction infringes Crown copyright and may lead to prosecution or civil proceedings
West Sussex County Council Licence No. 100023447

SCALE: 1:40,000
DATE: 19/03/2018

Key for Waiting Restrictions

All areas over which the provision of the orders apply are defined by the shaded areas as shown on the following plans plus a contiguous area not indicated on the plans of verge and/or footway between the carriageway edge and the highway boundary. The plans in this schedule are based upon grid references of the Ordnance Survey National Grid defined by the OSGB 36 triangulation.

Prohibition of waiting at any time

101		check	No waiting at any time	107		pat020	No waiting 8.00am-6.00pm Mon–Sat
-----	-----------------------------------------------------------------------------------	-------	------------------------	-----	-------------------------------------------------------------------------------------	--------	----------------------------------

Prohibition of loading

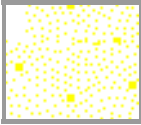
229		shd47	No waiting at any time, No loading and unloading 10.00am-6.00pm Mon-Sat
-----	-----------------------------------------------------------------------------------	-------	-------------------------------------------------------------------------------

Free Limited Waiting

713		pat063	Waiting limited to 2hrs No return within 2hrs 8.00am-6.00pm any day	716		shd62	Waiting limited to 1hr No return within 1hr 8.00am-6.00pm Mon–Sat
-----	-------------------------------------------------------------------------------------	--------	------------------------------------------------------------------------	-----	---------------------------------------------------------------------------------------	-------	----------------------------------------------------------------------

Specified Vehicles

830		check	Disabled persons vehicles at any time	845		usgs602	No waiting at any time except taxis
-----	-------------------------------------------------------------------------------------	-------	---------------------------------------	-----	---------------------------------------------------------------------------------------	---------	-------------------------------------

Clearways

1104		usgs620	Bus stop clearway 7.00am-7.00pm any day	1113		pat055	Bus stop clearway No stopping except buses 8.00am-6.00pm Mon-Sat
------	-------------------------------------------------------------------------------------	---------	-----------------------------------------	------	---------------------------------------------------------------------------------------	--------	---------------------------------------------------------------------

09/08 DELEGATED AUTHORITY

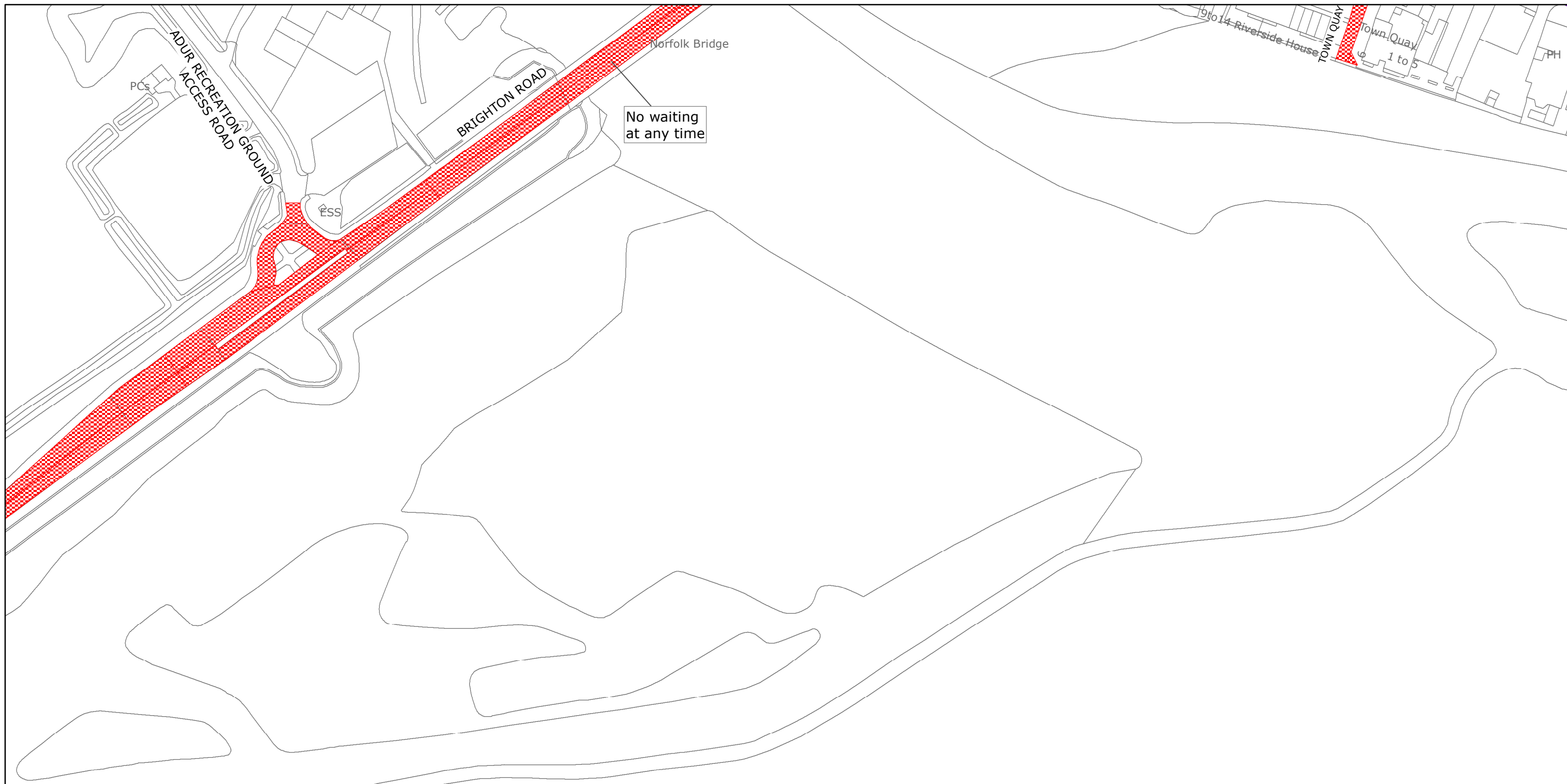

West Sussex County Council
Highways & Transport
The Grange
Tower Street
Chichester
West Sussex
PO19 1RH

ADUR DISTRICT: SHOREHAM/SOUTHWICK

WAITING RESTRICTIONS

Reproduced from or based upon 2018 Ordnance Survey mapping with permission of the Controller of HMSO (c) Crown Copyright reserved.
Unauthorised reproduction infringes Crown copyright and may lead to prosecution or civil proceedings West Sussex County Council Licence No. 100018485

TILE REF NO:
TQ2104NWN

SHEET ISSUE NO 2
SHEET ACTIVE FROM - 19/03/2018



SCALE:
1:1250
at A3 size

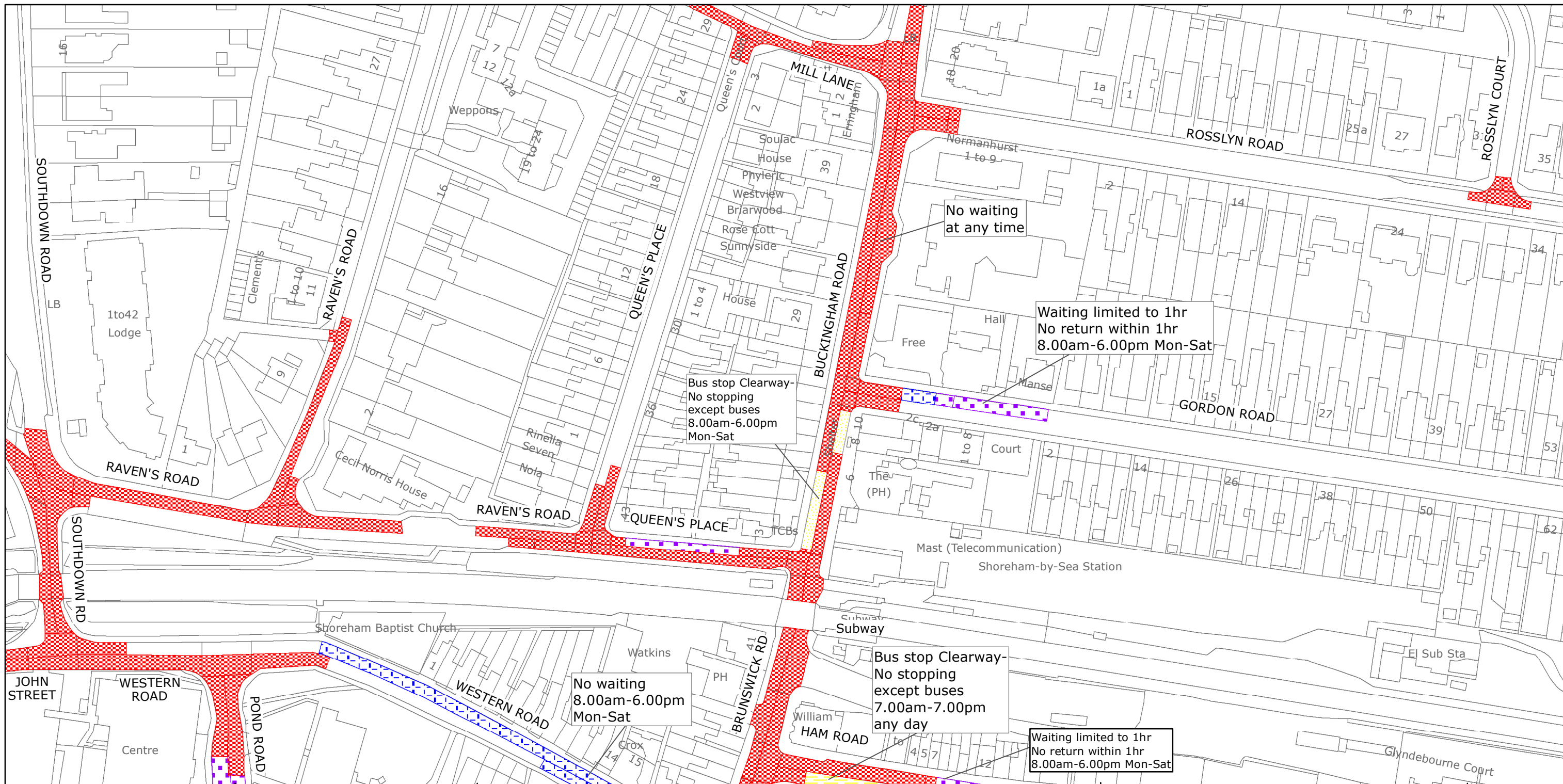

West Sussex County Council
Highways & Transport
The Grange
Tower Street
Chichester
West Sussex
PO19 1RH

ADUR DISTRICT: SHOREHAM/SOUTHWICK

WAITING RESTRICTIONS

Reproduced from or based upon 2018 Ordnance Survey mapping with permission of the Controller of HMSO (c) Crown Copyright reserved.
Unauthorised reproduction infringes Crown copyright and may lead to prosecution or civil proceedings West Sussex County Council Licence No. 100018485

TILE REF NO: TQ2105SEN

SHEET ISSUE NO 5
SHEET ACTIVE FROM - 19/03/2018



SCALE:
1:1250
at A3 size

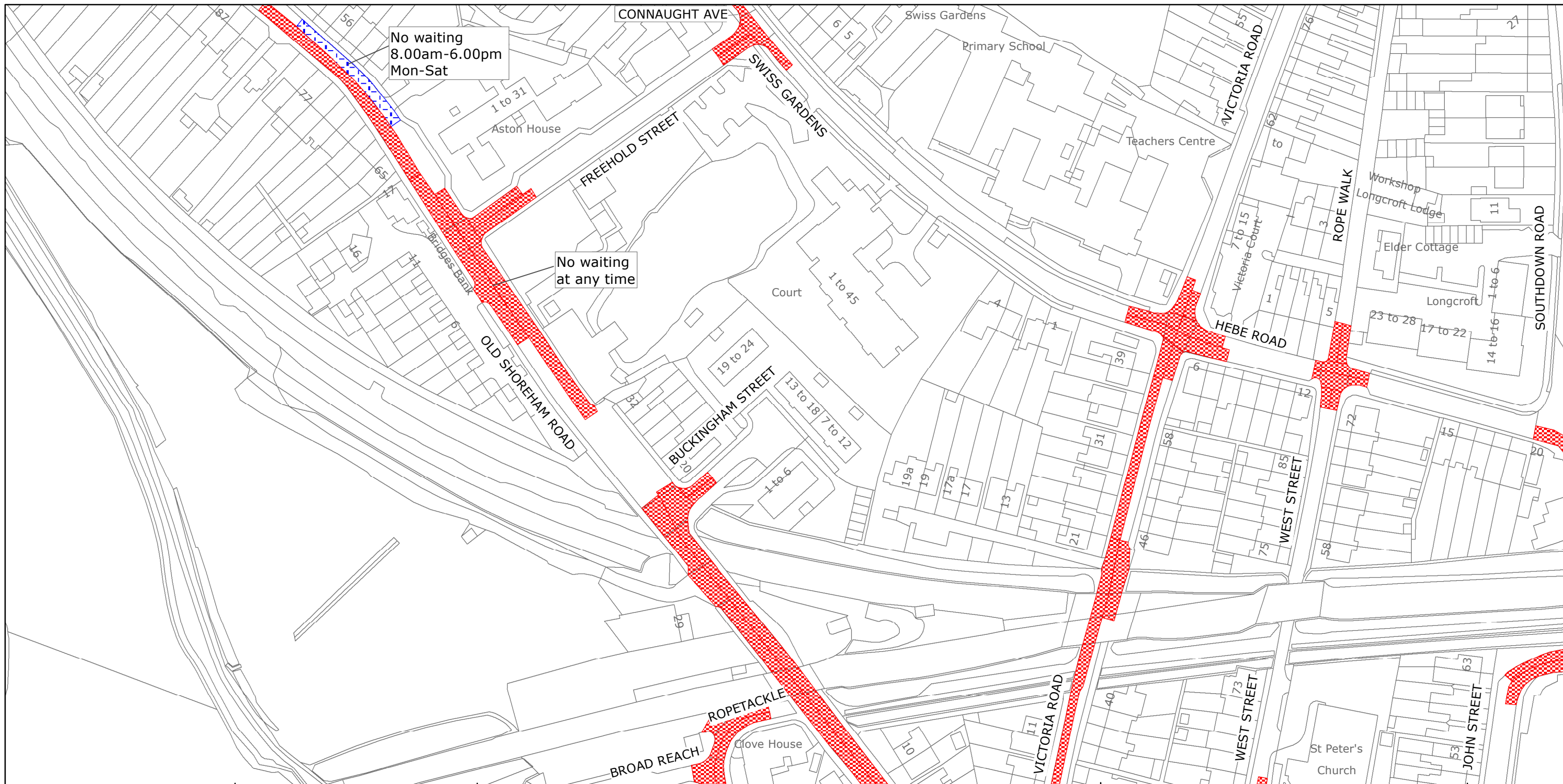

West Sussex County Council
Highways & Transport
The Grange
Tower Street
Chichester
West Sussex
PO19 1RH

ADUR DISTRICT: SHOREHAM/SOUTHWICK
WAITING RESTRICTIONS

Reproduced from or based upon 2018 Ordnance Survey mapping with permission of the Controller of HMSO (c) Crown Copyright reserved.
Unauthorised reproduction infringes Crown copyright and may lead to prosecution or civil proceedings West Sussex County Council Licence No. 100018485

TILE REF NO:
TQ2105SWN

SHEET ISSUE NO 4
SHEET ACTIVE FROM - 19/03/2018



SCALE:
1:1250
at A3 size

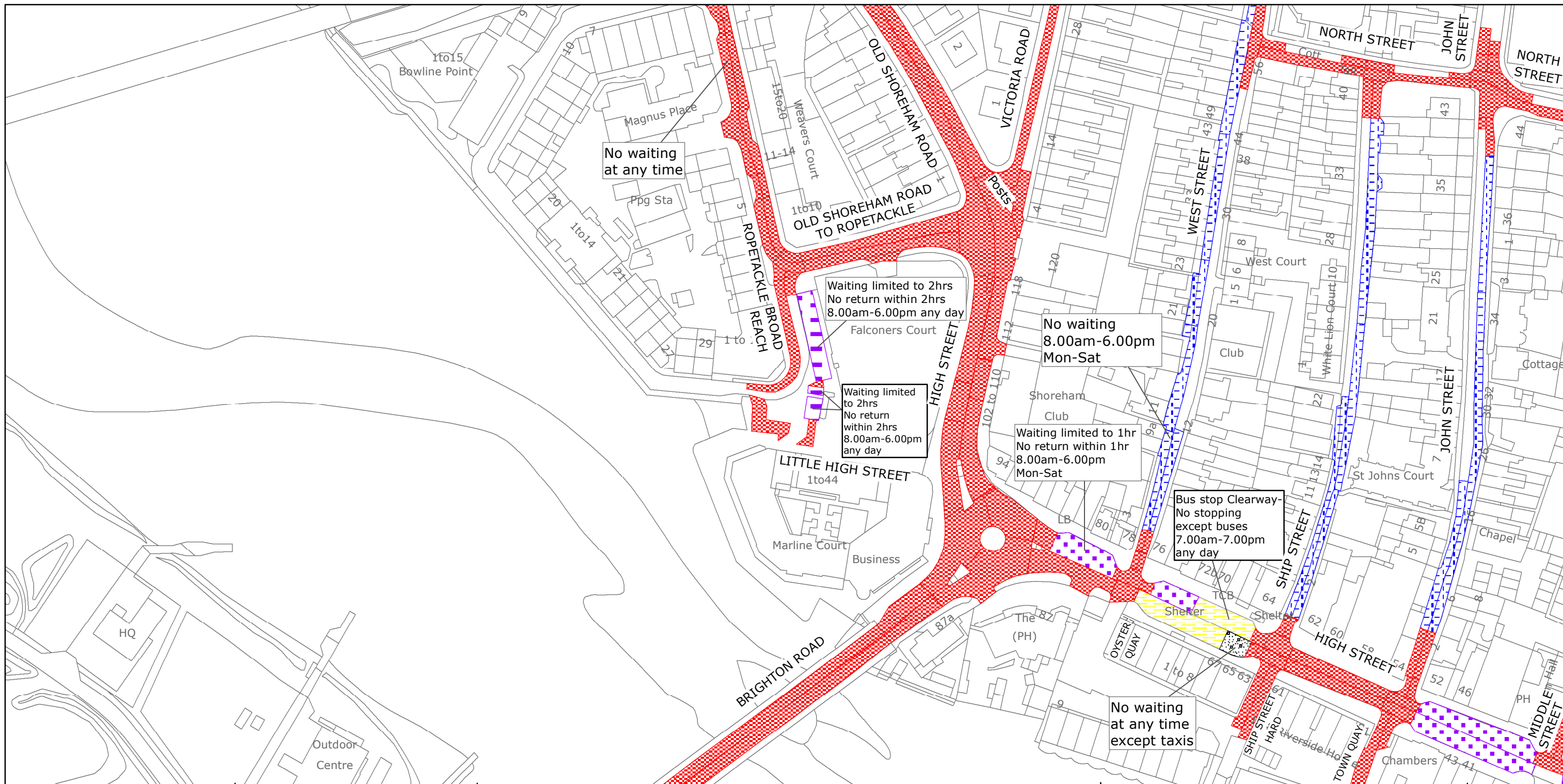

West Sussex County Council
Highways & Transport
The Grange
Tower Street
Chichester
West Sussex
PO19 1RH

ADUR DISTRICT: SHOREHAM/SOUTHWICK

WAITING RESTRICTIONS

Reproduced from or based upon 2018 Ordnance Survey mapping with permission of the Controller of HMSO (c) Crown Copyright reserved.
Unauthorised reproduction infringes Crown copyright and may lead to prosecution or civil proceedings West Sussex County Council Licence No. 100018485

TILE REF NO: TQ2105SWS

SHEET ISSUE NO 4
SHEET ACTIVE FROM - 19/03/2018



SCALE:
1:1250
at A3 size

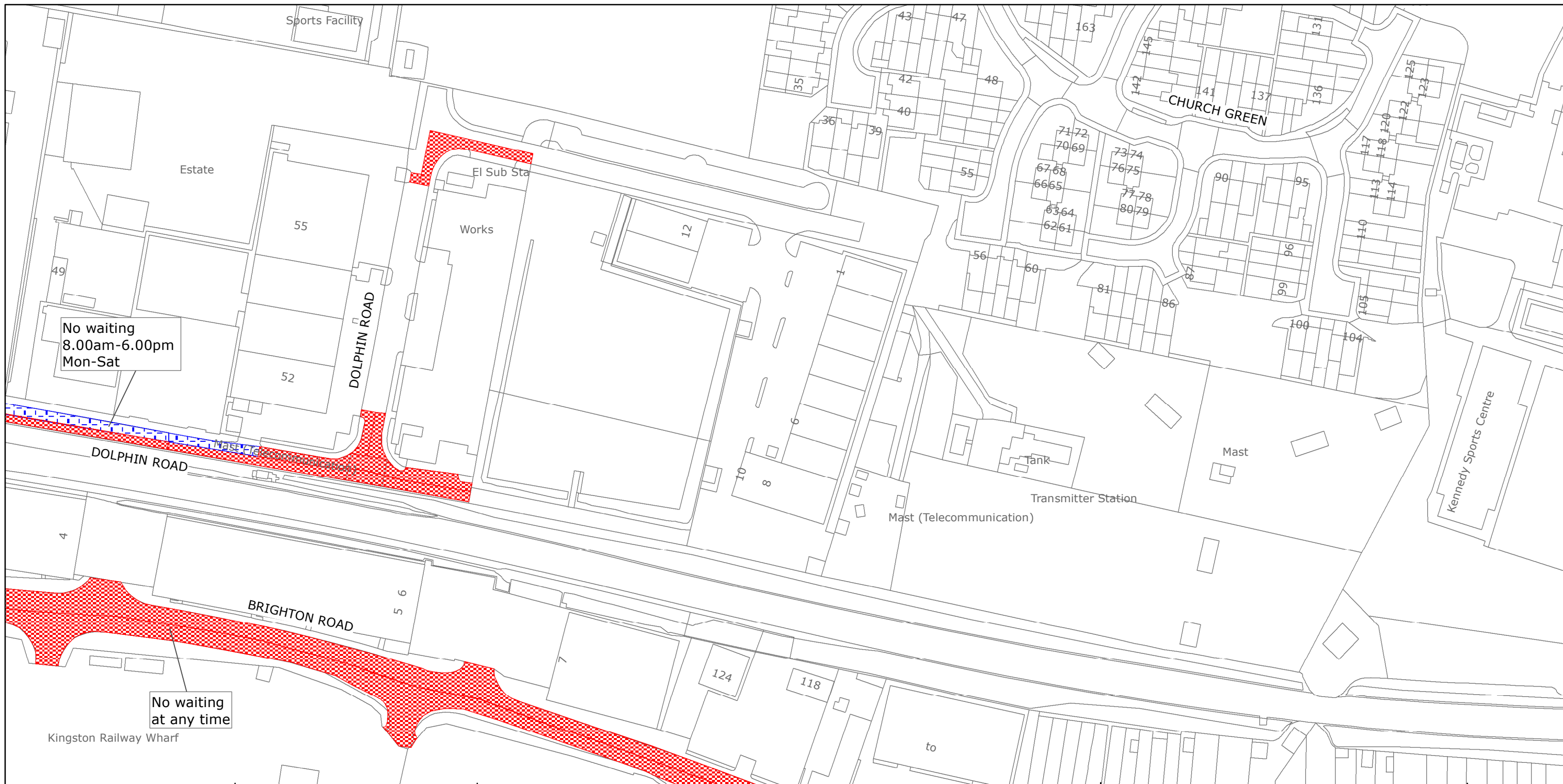

West Sussex County Council
Highways & Transport
The Grange
Tower Street
Chichester
West Sussex
PO19 1RH

ADUR DISTRICT: SHOREHAM/SOUTHWICK
WAITING RESTRICTIONS

Reproduced from or based upon 2018 Ordnance Survey mapping with permission of the Controller of HMSO (c) Crown Copyright reserved.
Unauthorised reproduction infringes Crown copyright and may lead to prosecution or civil proceedings West Sussex County Council Licence No. 100018485

TILE REF NO:
TQ2305SWS

SHEET ISSUE NO 2
SHEET ACTIVE FROM - 19/03/2018



SCALE:
1:1250
at A3 size